

VISTA CANYON MULTI-MODAL STATION SITE PLAN

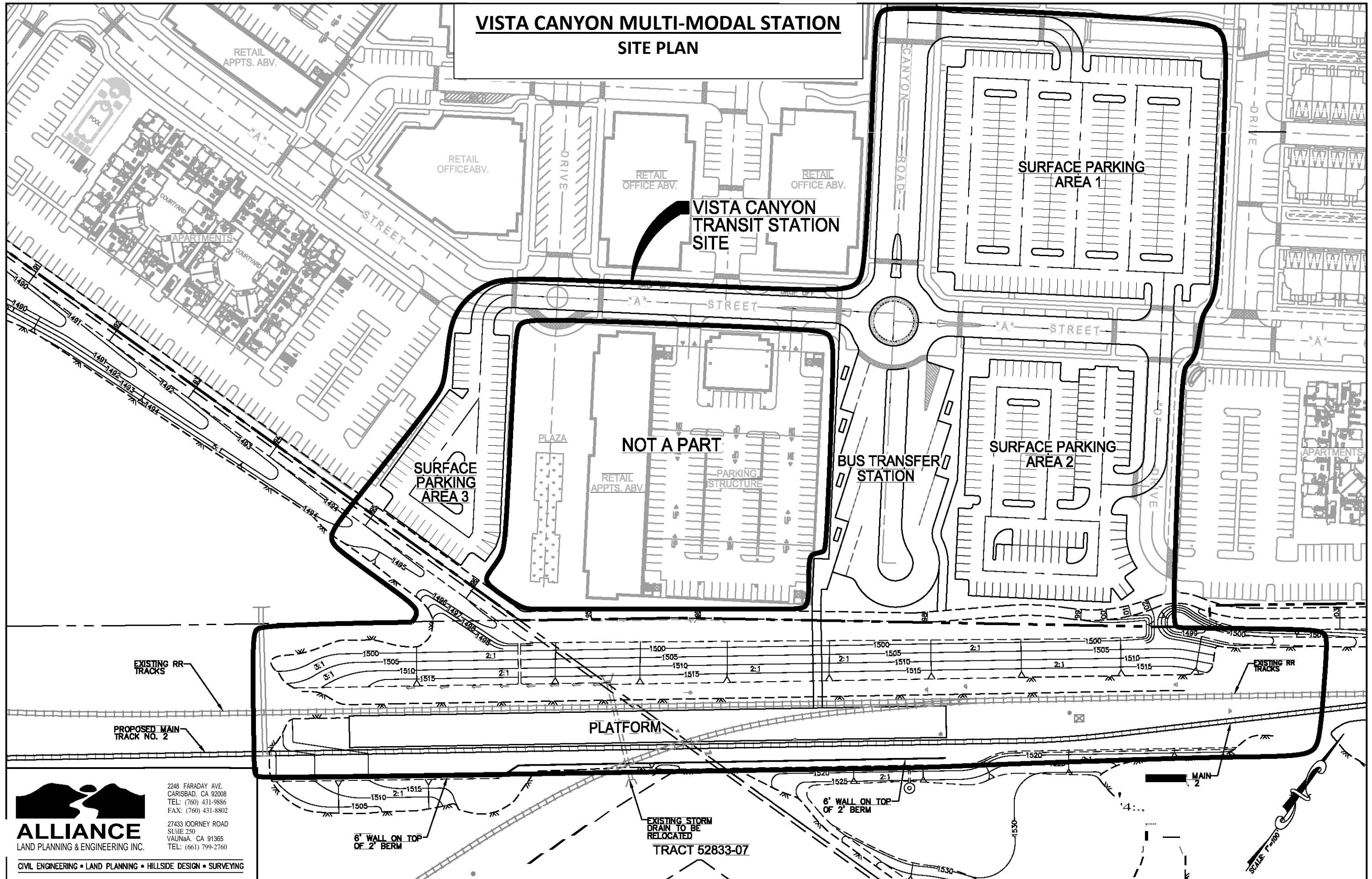

2248 FARADAY AVE.
CARISBAD, CA 92008
TEL: (760) 431-9886
FAX: (760) 431-8802

27433 IORNEY ROAD
SUITE 250
VALUANA, CA 91365
TEL: (661) 799-2760

CIVIL ENGINEERING • LAND PLANNING • HILLSIDE DESIGN • SURVEYING